

CUSTOMER TECHNICAL MEMO # 250

Subject: Double Glazed Wrap Around Glazing Channels

Date: October 2015

Good Morning All,

All Alspec Double Glazed Glazing Channels will now be supplied pre-punched with drainage holes through the base of the channel.

This is to minimise potential dangers associated with water damage to the perimeter sealant on Insulating Glass Units. This topic is well documented in AS4666, the Standard covering D.G. Units, where water may be trapped in the bottom rails, which can lead to the failure of the adhesive bond between the glass and the sealant.

With the glazing channels now allowing drainage from within the channel through to the rail, it is important to ensure that the rails are also drained to allow for total escape of any water. We have enclosed the new rail drainage details for your information prior to the relevant Technical Manuals being updated.

Products affected are D.G. Altitude, ProGlide and View-Max.

PRODUCT	GLASS	GLAZING CHANNEL
ALTITUDE	18mm	1376094
VIEW-MAX	16mm 18mm	GR66 - 1376070 GR53 - 1376087
PROGLIDE	18mm 24/25mm 28mm	GRS118 - 1376098 GRS24 - 1376101 GRS28 - 1376100

If you have any questions please do not hesitate to contact your local Alspec Area Manager or Sales Office.

Plain Sash Rail Preparation

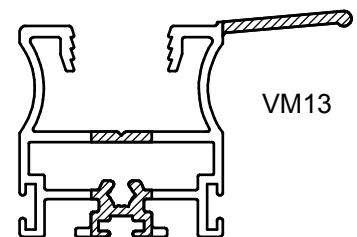
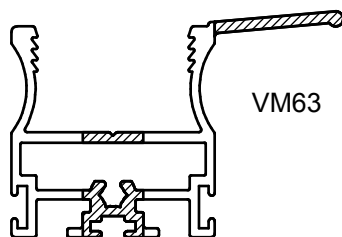
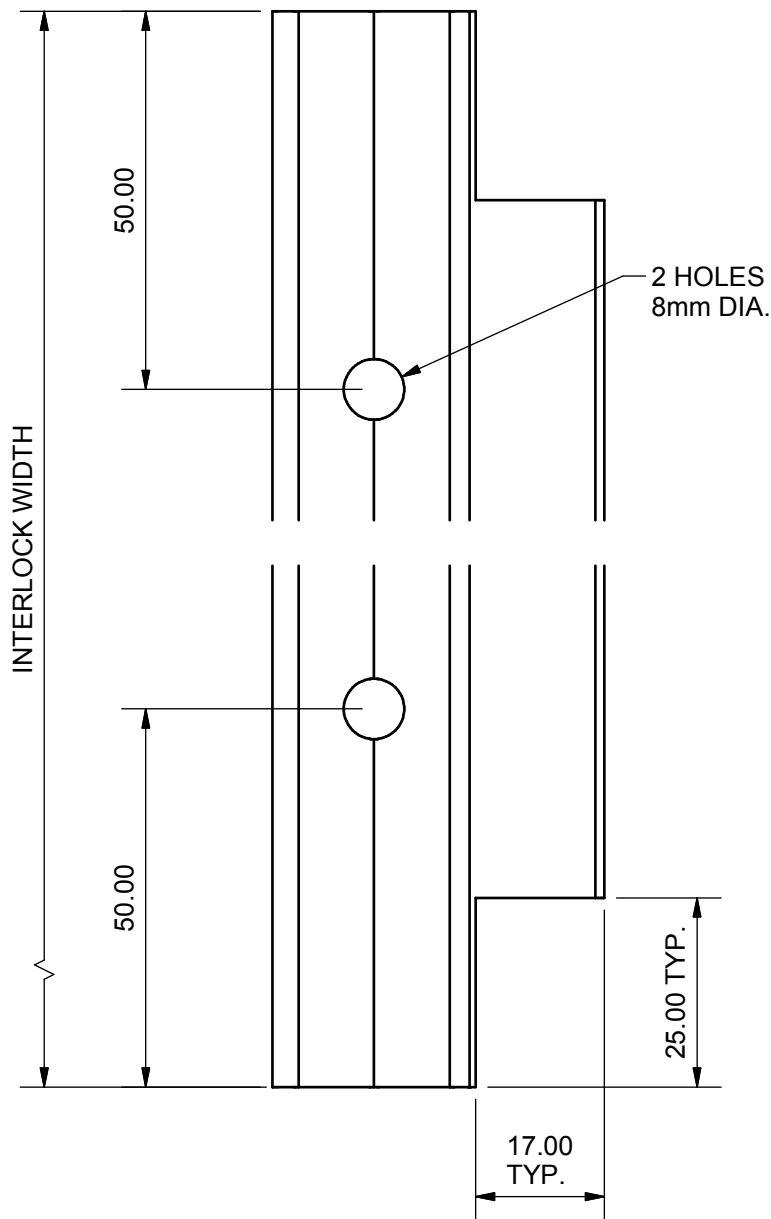

APT25 Bottom Rail Drainage

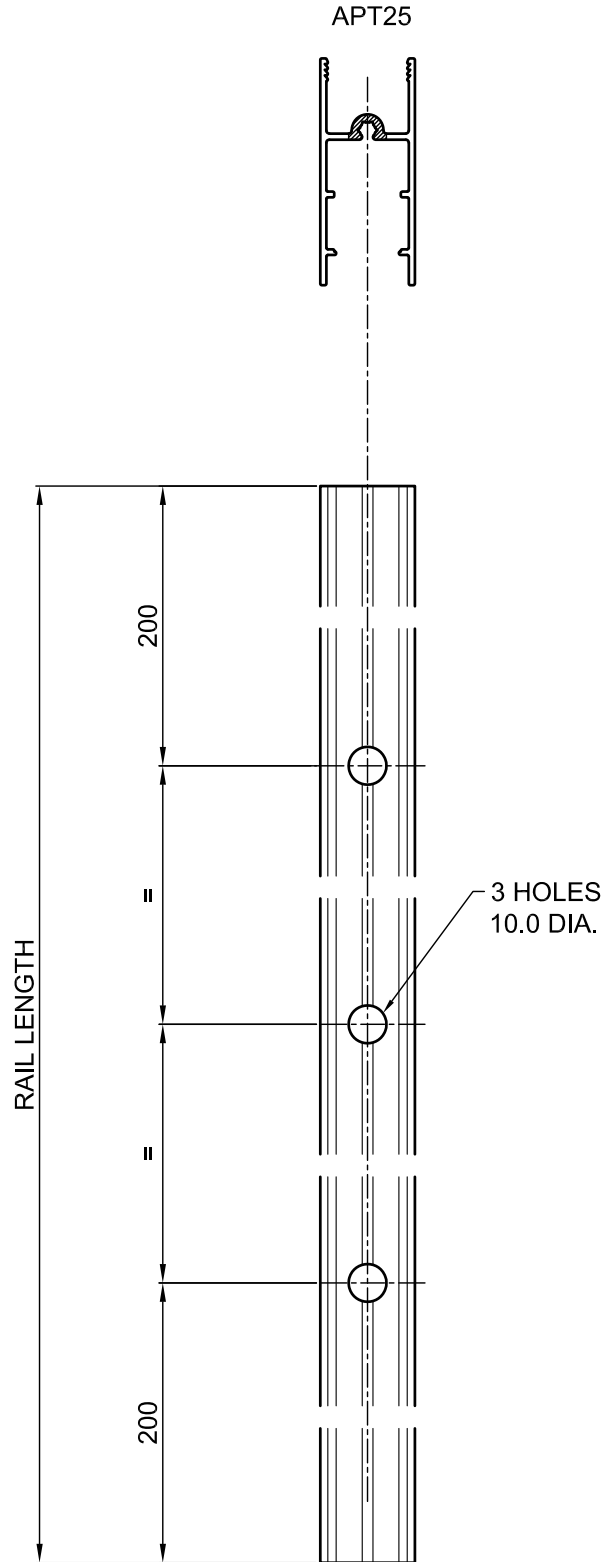

Wrap Around Glazing

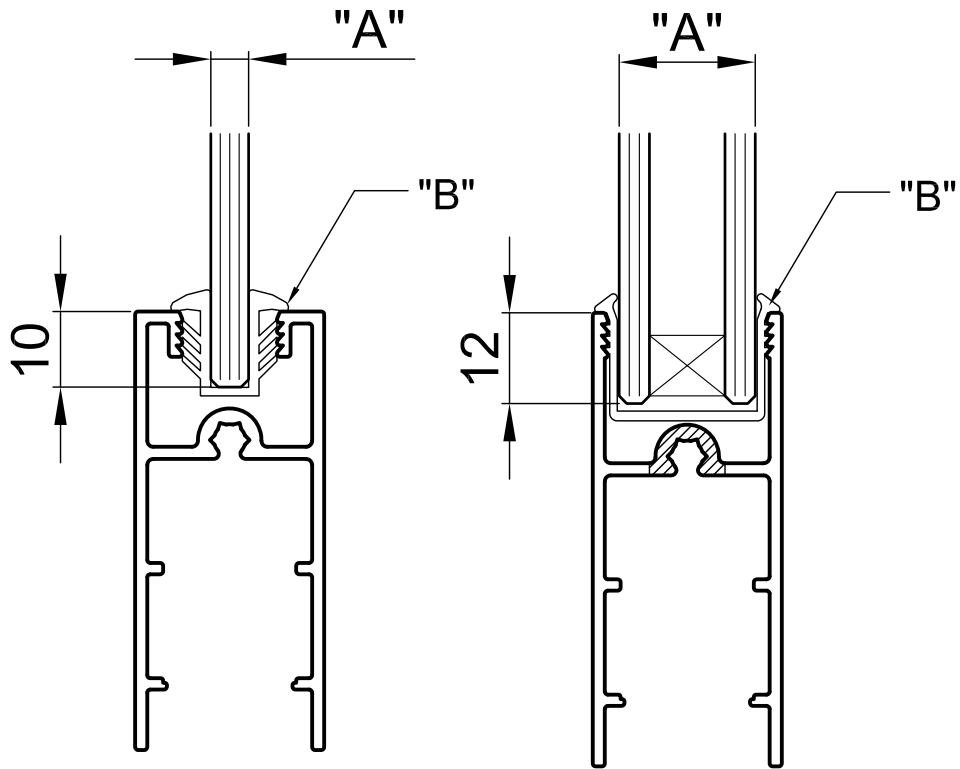

"A" GLASS THICKNESS	"B" GLAZING CHANNEL
4mm	GR59 Code 376030
5mm	GR60 Code 376033
6 - 6.35mm	GR61 Code 376032
8mm	GR62 Code 376034
10 - 10.38m	GR63 Code 376035
18mm	Code 376094
*USE DG EXTRUSIONS FOR 18mm GLASS	

Double Glazed Bottom Rail Preparations

AD778
28mm DOUBLE
GLAZED RAIL

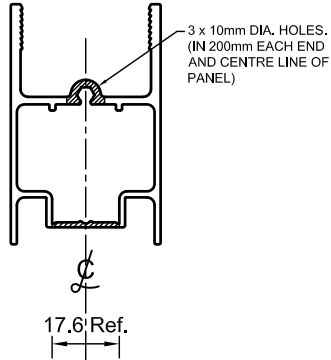

AD832
DG RAIL
(SITE GLAZED)

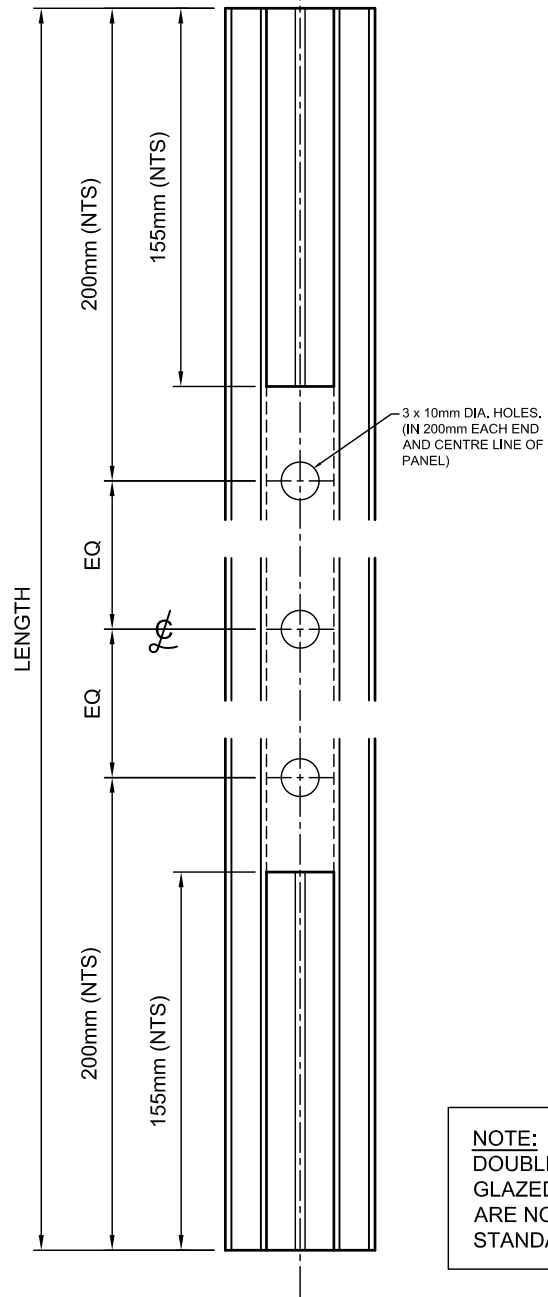
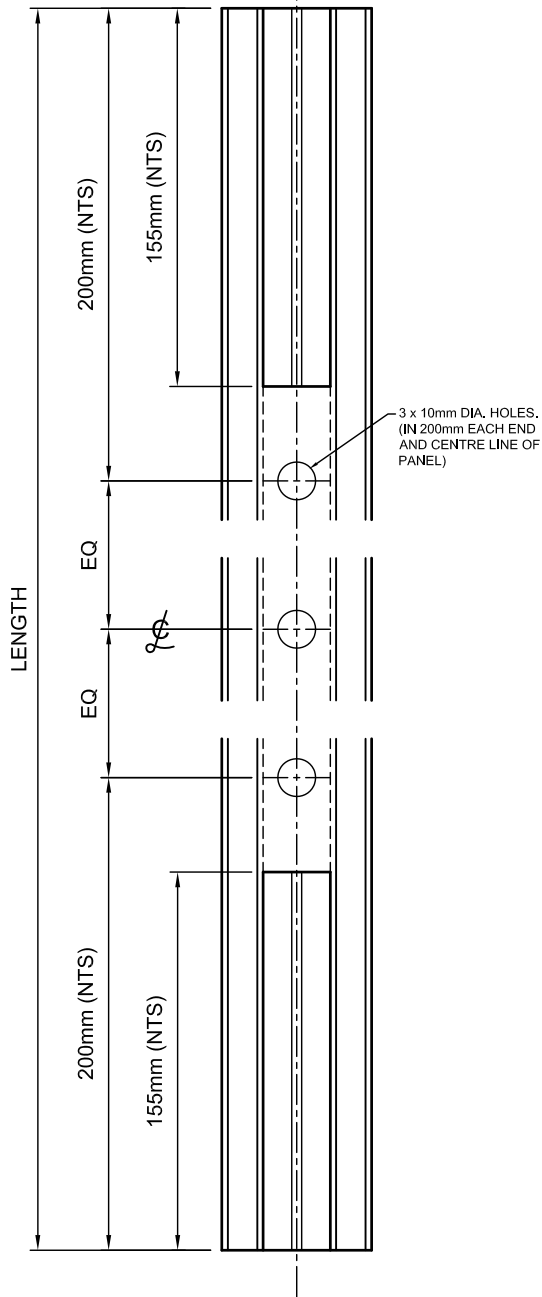
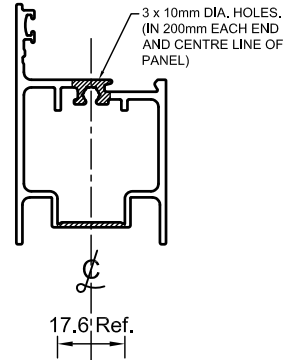

NOTE:
DOUBLE GLAZED SITE
GLAZED EXTRUSIONS
ARE NOT PART OF
STANDARD TOOLING

Double Glazed - 28mm DG Glazing Details

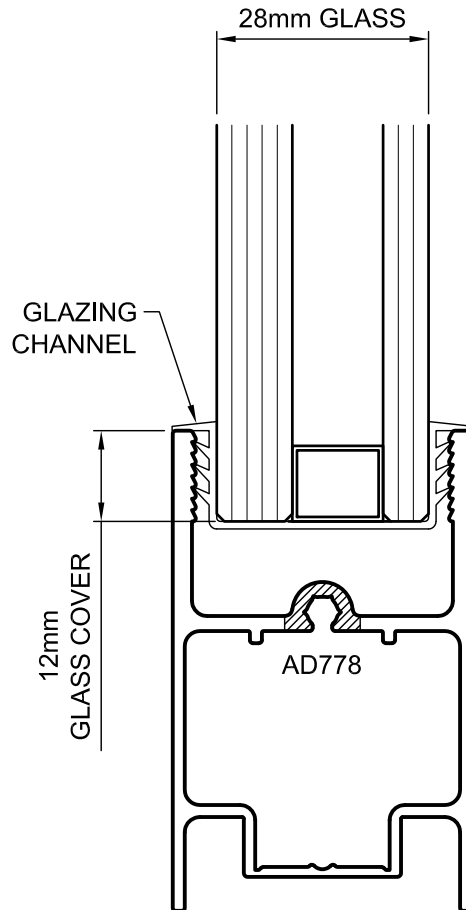

START AND FINISH GLAZING CHANNEL IN THE CENTRE OF THE TOP RAIL AND SILICONE SEAL ALL CORNERS WHERE GASKET IS CUT. ENSURE SILICONE IS COMPATIBLE WITH IGU.

GLASS THICKNESS	GLAZING CHANNEL
18mm THICK	GRS118
24 / 25mm THICK	GRS24
28mm THICK	GRS28

Double Glazed On Site Glazing Details

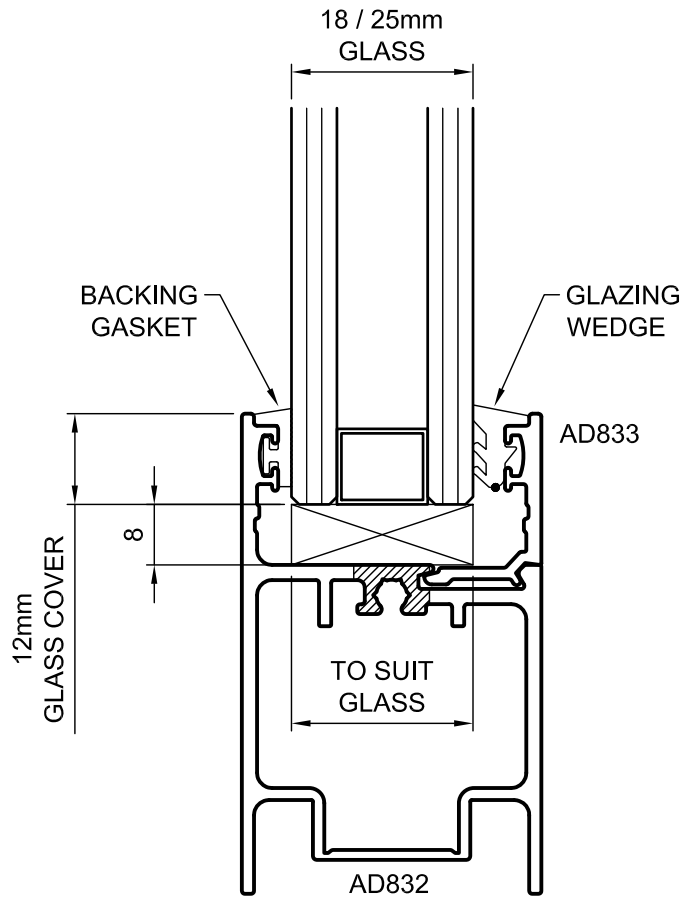

	WEDGE	PUSH IN BACKING GASKET	CO-EXTRUDED BACKING GASKET
GLASS THICKNESS	REF. (GAP)	REF. (GAP)	REF. (GAP)
18mm THICK	GR48 / GR48S (8mm)	GR37 / GR37S (4mm)	CE37 / CE37S (4mm)
24mm THICK	GR44 / GR44S (4mm)	GR36 / GR36S (2mm)	CE36 / CE36S (2mm)
25mm THICK	GR43 / GR43S (3mm)	GR36 / GR36S (2mm)	CE36 / CE36S (2mm)