

CUSTOMER TECHNICAL MEMO # 73

Subject: Hunter Technical Manual Glazing Detail Revisions

Date: 8/7/09

From: Product Development

Please note the following revisions have been made to the Hunter Technical Manuals.

Hunter 100 Flush Glazed Framing

Page 1.0 – Technical Manual Release Notes revised.

Page 3.7.1 – Glazing Details captive and roll in wedge combinations revised.

Hunter 150 Flush Glazed Framing

Page 1.0 – Technical Manual Release Notes revised.

Page 3.7.1 – Glazing Details captive and roll in wedge combinations revised.

Hunter 100 Double Glazed Flush Glazed Framing

Page 1.0 – Technical Manual Release Notes revised.

Page 3.7.1 – Glazing Details Non Captive title added.

Page 3.7.2 – Captive Glazing Details page added.

Hunter 150 Double Glazed Flush Glazed Framing

Page 1.0 – Technical Manual Release Notes revised.

Page 3.7.1 – Glazing Details Non Captive title added.

Page 3.7.2 – Captive Glazing Details page added.

The above revised manuals dated July09 can be found on the ALSPEC website.

Please note all the above pages are included with this Technical Memo for your information. The format for the Memo has been set for double sided printing so you will be able to easily replace the pages in your manuals. However, you will need to ensure your printer is set to double-sided printing for this to work.

If you have any questions please do not hesitate to contact your local ALSPEC Area Manager or Sales Office.

ALSPEC ALUMINIUM SYSTEMS

TECHNICAL MANUAL

HUNTER 100mm FLUSHGLAZED FRAMING

Section 1.0

TECHNICAL MANUAL RELEASE NOTES

This page is intended to record all changes to the **HUNTER 100 FLUSHGLAZED FRAMING** technical manual pages. It is therefore critical that all changes are recorded in the below AMENDMENTS box prior to release to our customer.

Changes or additions to this manual will be itemised with a brief description and date when the amendments were made.

It is important that a copy of this page be issued with the update and inserted as the first page in the customers technical manual.

DATE	AMENDMENT DESCRIPTION	REMOVE PAGE	INSERT NEW PAGE
01 / 09 / 2008	<i>Technical manual initial release</i>	~	~
01 / 02 / 2009	<i>Technical manual release notes amended</i>	1.0	1.0
01 / 02 / 2009	<i>Loading table explanation page added</i>	2.2	2.2
01 / 02 / 2009	<i>Loading table maximum stress amended</i>	2.2.1 to 2.2.7	2.2.1 to 2.2.7
01 / 02 / 2009	<i>Glazing Details – Captive Framing Internal Glazing</i>	3.7.1	3.7.1
01 / 02 / 2009	<i>Extrusions</i>	3.1.3	3.1.3
01 / 02 / 2009	<i>Typical Head & Sill Details - Internal Glazing</i>	3.4.3	3.4.3
01 / 02 / 2009	<i>Typical Frame Preparation 5 - Internal Glazing</i>	3.6.5	3.6.5
01 / 02 / 2009	<i>Typical Frame Preparation 6</i>	3.6.6	3.6.6
01 / 02 / 2009	<i>Typical Frame Preparation 7</i>	3.6.7	3.6.7
01 / 02 / 2009	<i>Typical Frame Preparation 8</i>	3.6.8	3.6.8
01 / 02 / 2009	<i>Typical Drainage Preparation</i>	3.6.10	3.6.10
01 / 02 / 2009	<i>Glazing Wedges</i>	3.2.1	3.2.1
01 / 02 / 2009	<i>Glazing Details - Captive Framing Internal Glazing</i>	3.7.1	3.7.1
01 / 02 / 2009	<i>Specification amended</i>	2.1	2.1
01 / 07 / 2009	<i>Technical manual release notes amended</i>	1.0	1.0
01 / 07 / 2009	<i>Glazing Details - Captive Glazing amended</i>	3.7.1	3.7.1

GLAZING DETAILS - CAPTIVE FRAMING

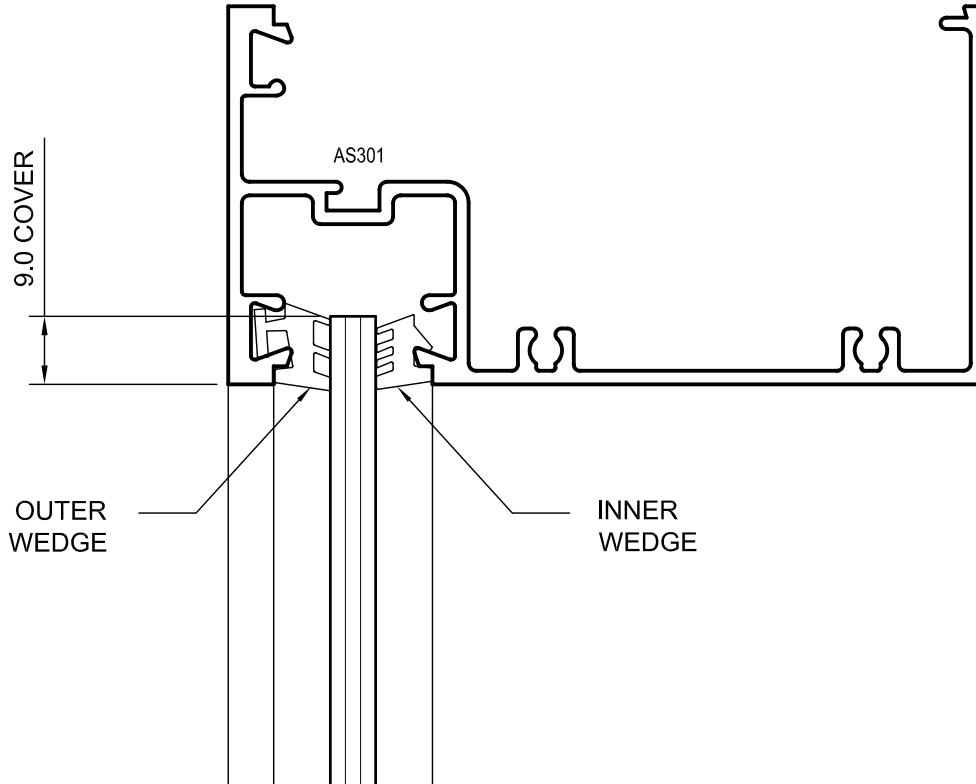

GLASS THICKNESS	OUTER WEDGE		INNER WEDGE	
	REF.	CODE	REF.	CODE
6mm THICK	CE16	376353	GR26	376119
6.38mm THICK	CE16	376353	GR26	376119
8mm THICK	CE16	376353	GR4	376021
8.38mm THICK	CE16	376353	GR4	376021
10mm THICK	CE16	376353	GR3	376015
10.38mm THICK	CE16	376353	GR3	376015

REVERSE GLAZING WEDGE COMBINATIONS FOR EXTERNAL GLAZING

GLAZING DETAILS - NON CAPTIVE FRAMING

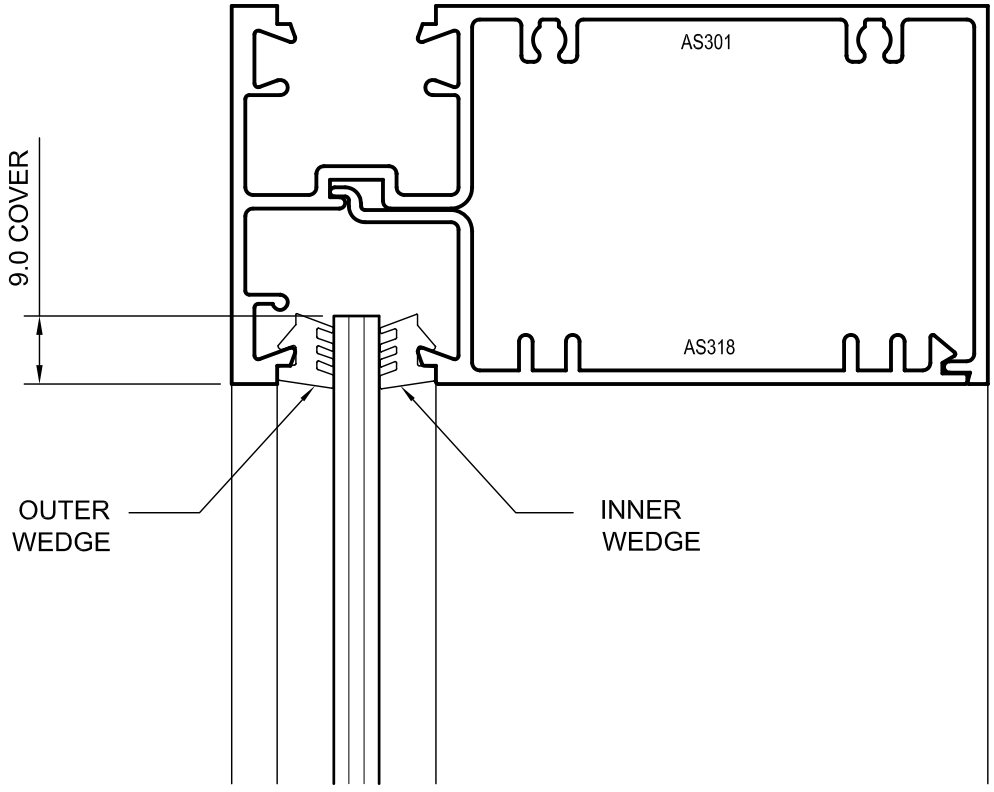

GLASS THICKNESS	OUTER WEDGE		INNER WEDGE	
	REF.	CODE	REF.	CODE
6mm THICK	GR4	376021	GR4	376021
6.38mm THICK	GR4	376021	GR4	376021
8mm THICK	GR3	376015	GR3	376015
8.38mm THICK	GR3	376015	GR3	376015
10mm THICK	GR3	376015	GR2	376012
10.38mm THICK	GR3	376015	GR2	376012

ALSPEC ALUMINIUM SYSTEMS

TECHNICAL MANUAL

HUNTER 150mm FLUSHGLAZED FRAMING

Section 1.0

TECHNICAL MANUAL RELEASE NOTES

This page is intended to record all changes to the **HUNTER 150 FLUSHGLAZED FRAMING** technical manual pages. It is therefore critical that all changes are recorded in the below AMENDMENTS box prior to release to our customer.

Changes or additions to this manual will be itemised with a brief description and date when the amendments were made.

It is important that a copy of this page be issued with the update and inserted as the first page in the customers technical manual.

DATE	AMENDMENT DESCRIPTION	REMOVE PAGE	INSERT NEW PAGE
01 / 09 / 2008	<i>Technical manual initial release</i>	~	~
01 / 02 / 2009	<i>Technical manual release notes amended</i>	1.0	1.0
01 / 02 / 2009	<i>Loading table explanation page added</i>	2.2	2.2
01 / 02 / 2009	<i>Loading table maximum stress added</i>	2.2.1 to 2.2.4	2.2.1 to 2.2.4
01 / 02 / 2009	<i>Glazing details - Captive framing internal glazing</i>	3.7.1	3.7.1
01 / 02 / 2009	<i>Extrusions</i>	3.1.3	3.1.3
01 / 02 / 2009	<i>Typical Head & Sill Details - Internal Glaze</i>	3.4.3	3.4.3
01 / 02 / 2009	<i>Typical Frame Preparation 4 - Internal Glaze</i>	3.6.4	3.6.4
01 / 02 / 2009	<i>Typical Frame Preparation 5 - Internal Glaze</i>	3.6.5	3.6.5
01 / 02 / 2009	<i>Typical Frame Preparation 6 - Internal Glaze</i>	3.6.6	3.6.6
01 / 02 / 2009	<i>Transom Drainage Preparation</i>	3.6.8	3.6.8
01 / 02 / 2009	<i>Specification amended</i>	2.1	2.1
01 / 07 / 2009	<i>Technical manual release notes amended</i>	1.0	1.0
01 / 07 / 2009	<i>Glazing details - Captive glazing amended</i>	3.7.1	3.7.1

GLAZING DETAILS - CAPTIVE FRAMING

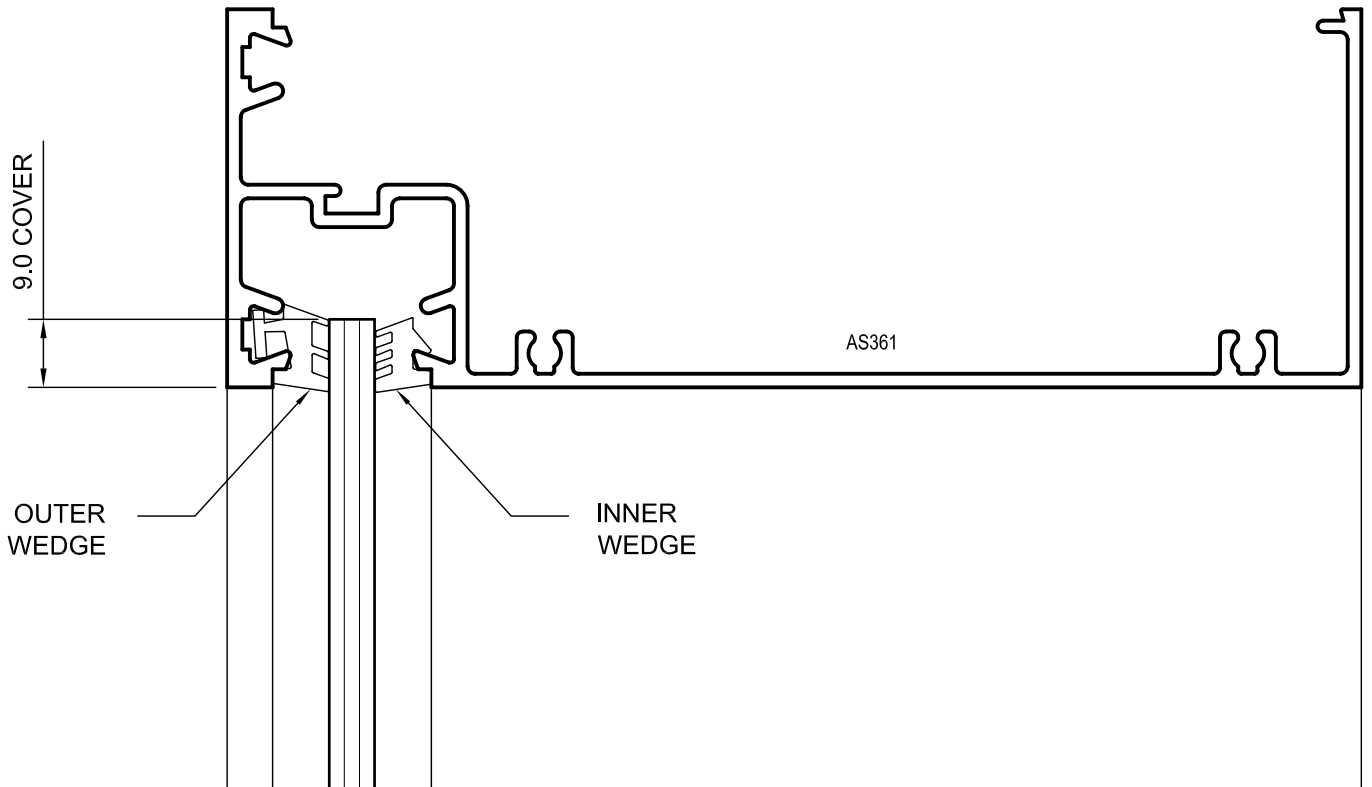

GLASS THICKNESS	OUTER WEDGE		INNER WEDGE	
	REF.	CODE	REF.	CODE
6mm THICK	CE16	376353	GR26	376119
6.38mm THICK	CE16	376353	GR26	376119
8mm THICK	CE16	376353	GR4	376021
8.38mm THICK	CE16	376353	GR4	376021
10mm THICK	CE16	376353	GR3	376015
10.38mm THICK	CE16	376353	GR3	376015

REVERSE GLAZING WEDGE COMBINATIONS FOR EXTERNAL GLAZING

GLAZING DETAILS - NON CAPTIVE FRAMING

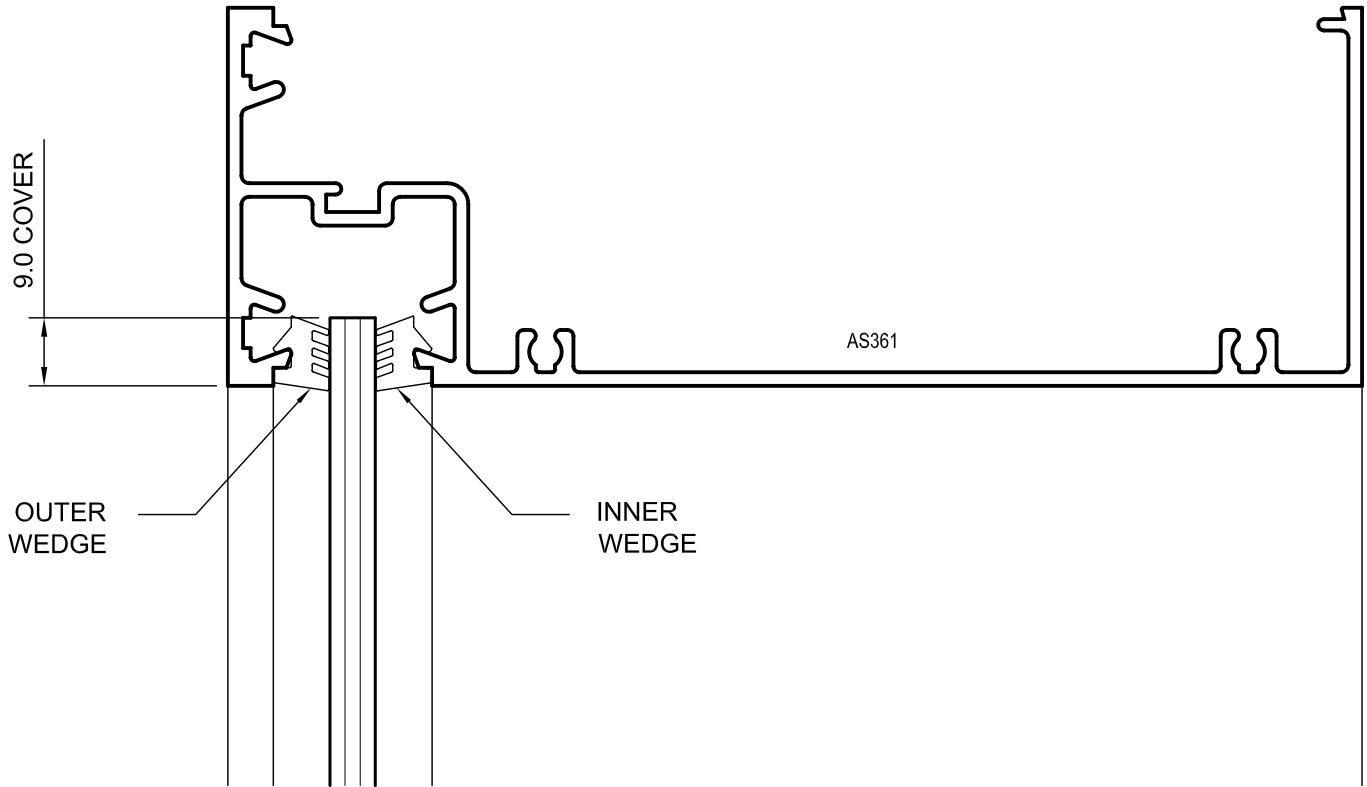

GLASS THICKNESS	OUTER WEDGE		INNER WEDGE	
	REF.	CODE	REF.	CODE
6mm THICK	GR4	376021	GR4	376021
6.38mm THICK	GR4	376021	GR4	376021
8mm THICK	GR3	376015	GR3	376015
8.38mm THICK	GR3	376015	GR3	376015
10mm THICK	GR3	376015	GR2	376012
10.38mm THICK	GR3	376015	GR2	376012

ALSPEC ALUMINIUM SYSTEMS

TECHNICAL MANUAL

HUNTER 100mm DOUBLE GLAZED FLUSHGLAZED FRAMING

Section 1.0

TECHNICAL MANUAL RELEASE NOTES

This page is intended to record all changes to the **HUNTER 100 DOUBLE GLAZED FLUSHGLAZED FRAMING** technical manual pages. It is therefore critical that all changes are recorded in the below AMENDMENTS box prior to release to our customer.

Changes or additions to this manual will be itemised with a brief description and date when the amendments were made.

It is important that a copy of this page be issued with the update and inserted as the first page in the customers technical manual.

DATE	AMENDMENT DESCRIPTION	REMOVE PAGE	INSERT NEW PAGE
01 / 09 / 2008	<i>Technical manual initial release</i>	~	~
01 / 02 / 2009	<i>Technical manual release notes amended</i>	1.0	1.0
01 / 02 / 2009	<i>Loading table explanation page added</i>	2.2	2.2
01 / 02 / 2009	<i>Loading table maximum stress amended</i>	2.2.1 to 2.2.2	2.2.1 to 2.2.2
01 / 02 / 2009	<i>Extrusions</i>	3.1.2	3.1.2
01 / 02 / 2009	<i>Extrusions</i>	3.1.3	3.1.3
01 / 02 / 2009	<i>Typical Head & Sill details - Internal Glaze</i>	3.4.3	3.4.3
01 / 02 / 2009	<i>Typical Frame Preparation 4</i>	3.6.4	3.6.4
01 / 02 / 2009	<i>Typical Frame Preparation 5</i>	3.6.5	3.6.5
01 / 02 / 2009	<i>Typical Frame Preparation 6</i>	3.6.6	3.6.6
01 / 02 / 2009	<i>Typical Drainage Preparation</i>	3.6.8	3.6.8
01 / 02 / 2009	<i>Specification amended</i>	2.1	2.1
01 / 07 / 2009	<i>Technical manual release notes amended</i>	1.0	1.0
01 / 07 / 2009	<i>Glazing details amended to Non Captive</i>	3.7.1	3.7.1
01 / 07 / 2009	<i>Glazing details amended to Captive - New Page</i>	~	3.7.2

GLAZING DETAILS - NON CAPTIVE

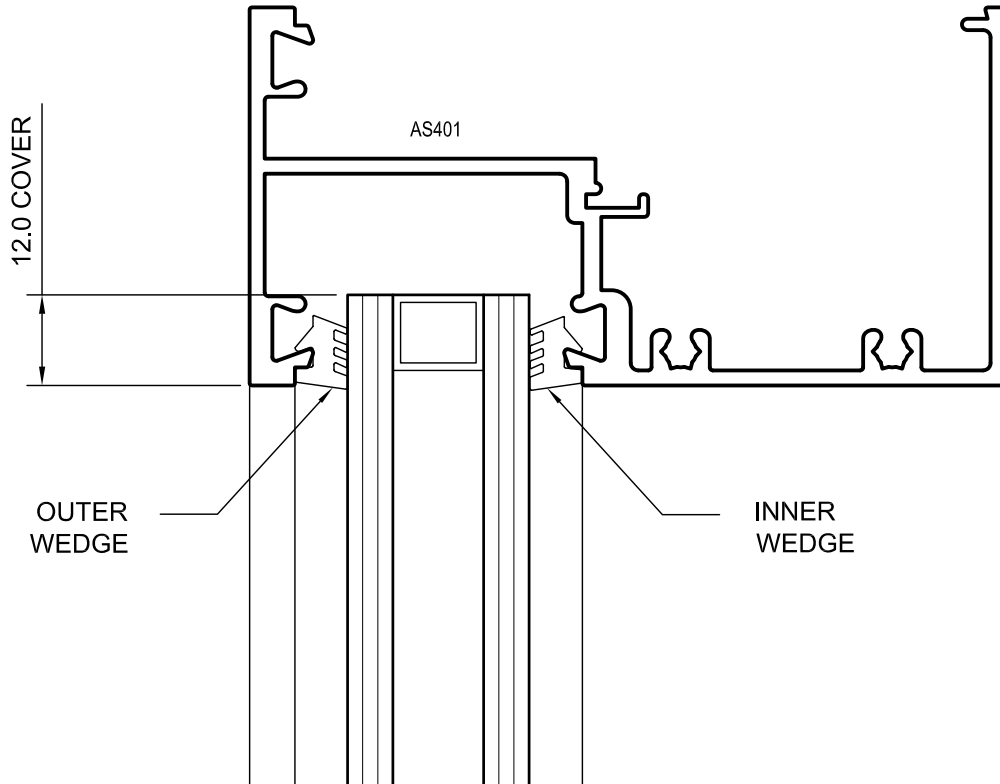

GLASS THICKNESS	OUTER WEDGE		INNER WEDGE	
	REF.	CODE	REF.	CODE
24mm THICK	GR3	376015	GR4	376021
26mm THICK	GR2	376012	GR4	376021
28mm THICK	GR2	376012	GR3	376015

REVERSE GLAZING WEDGE COMBINATIONS FOR EXTERNAL GLAZING

GLAZING DETAILS - CAPTIVE GLAZING

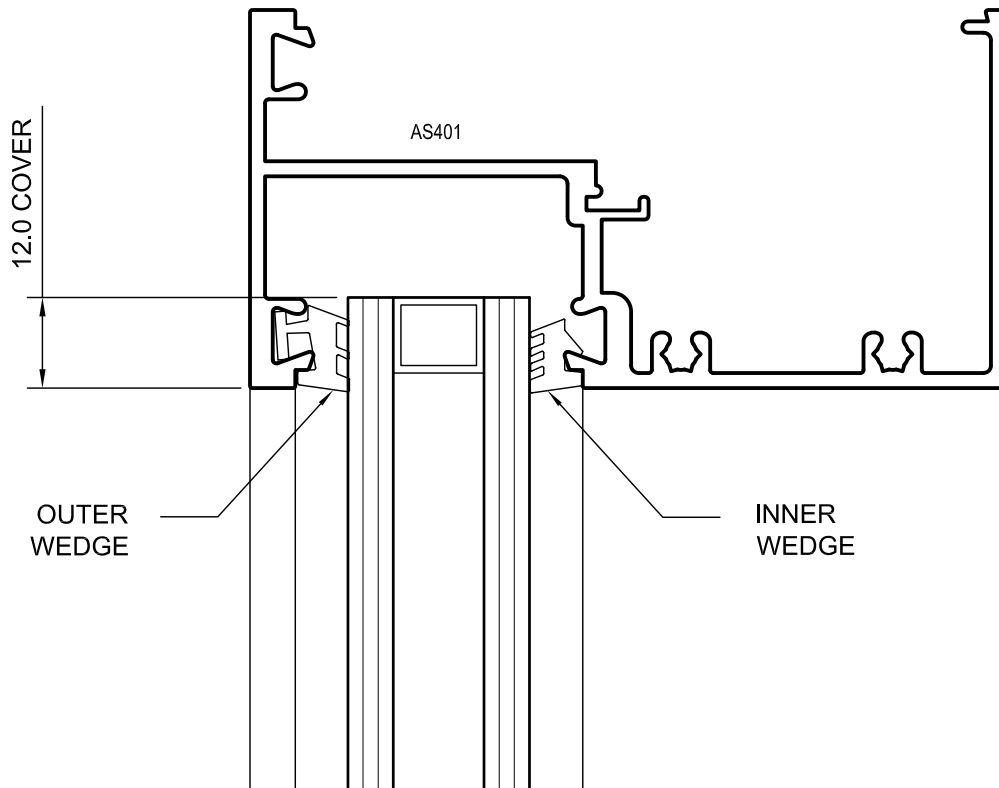

GLASS THICKNESS	OUTER WEDGE		INNER WEDGE	
	REF.	CODE	REF.	CODE
24mm THICK	CE16	376353	GR4	376021
26mm THICK	CE16	376353	GR3	376015
28mm THICK	CE16	376353	GR2	376012

REVERSE GLAZING WEDGE COMBINATIONS FOR EXTERNAL GLAZING

ALSPEC ALUMINIUM SYSTEMS

TECHNICAL MANUAL

HUNTER 150mm DOUBLE GLAZED FLUSHGLAZED FRAMING

Section 1.0

TECHNICAL MANUAL RELEASE NOTES

This page is intended to record all changes to the **HUNTER 150 DOUBLE GLAZED FLUSHGLAZED FRAMING** technical manual pages. It is therefore critical that all changes are recorded in the below AMENDMENTS box prior to release to our customer.

Changes or additions to this manual will be itemised with a brief description and date when the amendments were made.

It is important that a copy of this page be issued with the update and inserted as the first page in the customers technical manual.

DATE	AMENDMENT DESCRIPTION	REMOVE PAGE	INSERT NEW PAGE
01 / 09 / 2008	<i>Technical manual initial release</i>	~	~
01 / 02 / 2009	<i>Technical manual release notes amended</i>	1.0	1.0
01 / 02 / 2009	<i>Loading table explanation added</i>	2.2	2.2
01 / 02 / 2009	<i>Loading table maximum stress amended</i>	2.2.1 to 2.2.2	2.2.1 to 2.2.2
01 / 02 / 2009	<i>Extrusions</i>	3.1.2	3.1.2
01 / 02 / 2009	<i>Extrusions</i>	3.1.4	3.1.4
01 / 02 / 2009	<i>Extrusions</i>	3.1.5	3.1.5
01 / 02 / 2009	<i>Typical Jamb & Mullion details</i>	3.4.2	3.4.2
01 / 02 / 2009	<i>Typical Head & Sill details - Internal Glaze</i>	3.4.3	3.4.3
01 / 02 / 2009	<i>Typical frame preparation 4</i>	3.6.4	3.6.4
01 / 02 / 2009	<i>Typical frame preparation 5</i>	3.6.5	3.6.5
01 / 02 / 2009	<i>Typical frame preparation 6</i>	3.6.6	3.6.6
01 / 02 / 2009	<i>Transom drainage preparation</i>	3.6.8	3.6.8
01 / 02 / 2009	<i>Glazing Wedges</i>	3.2.1	3.2.1
01 / 02 / 2009	<i>Glazing Details - Captive Framing Internal Glazing</i>	3.7.1	3.7.1
01 / 02 / 2009	<i>Specification amended</i>	2.1	2.1
01 / 07 / 2009	<i>Technical manual release notes amended</i>	1.0	1.0
01 / 07 / 2009	<i>Glazing Details - amended to Non Captive</i>	3.7.1	3.7.1
01 / 07 / 2009	<i>Glazing Details Captive - New page</i>	~	3.7.2

GLAZING DETAILS - NON CAPTIVE

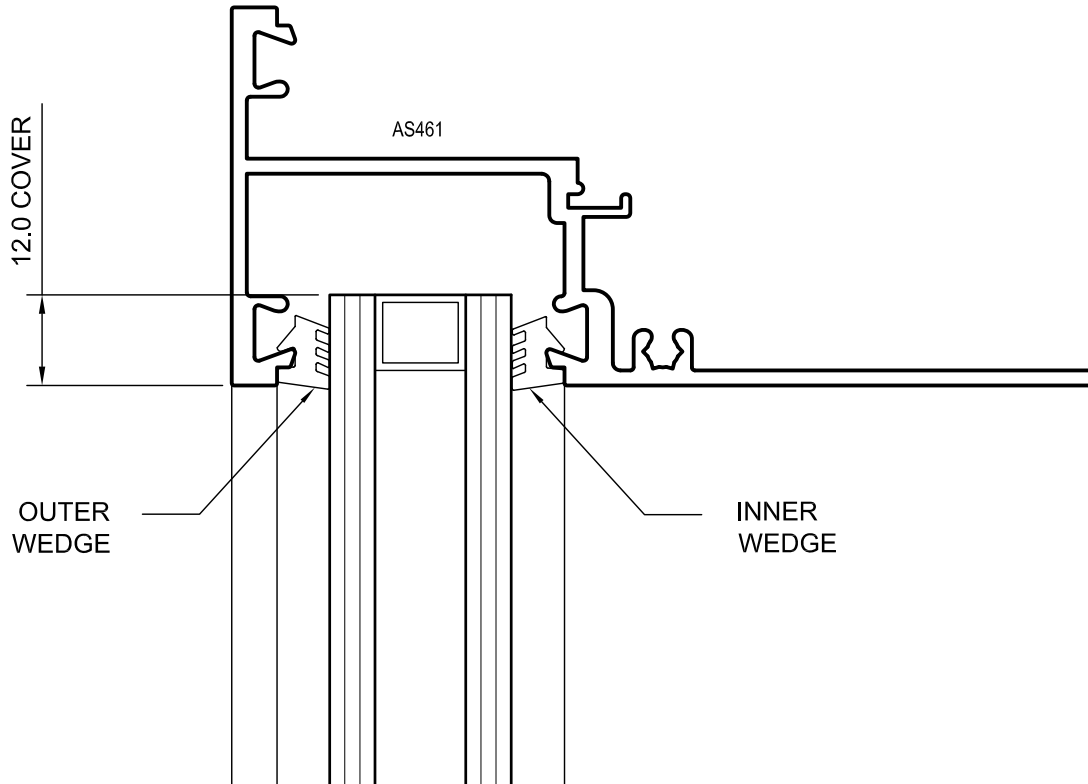

GLASS THICKNESS	OUTER WEDGE		INNER WEDGE	
	REF.	CODE	REF.	CODE
24mm THICK	GR3	376015	GR4	376021
26mm THICK	GR2	376012	GR4	376021
28mm THICK	GR2	376012	GR3	376015

REVERSE GLAZING WEDGE COMBINATIONS FOR EXTERNAL GLAZING

GLAZING DETAILS - CAPTIVE GLAZING

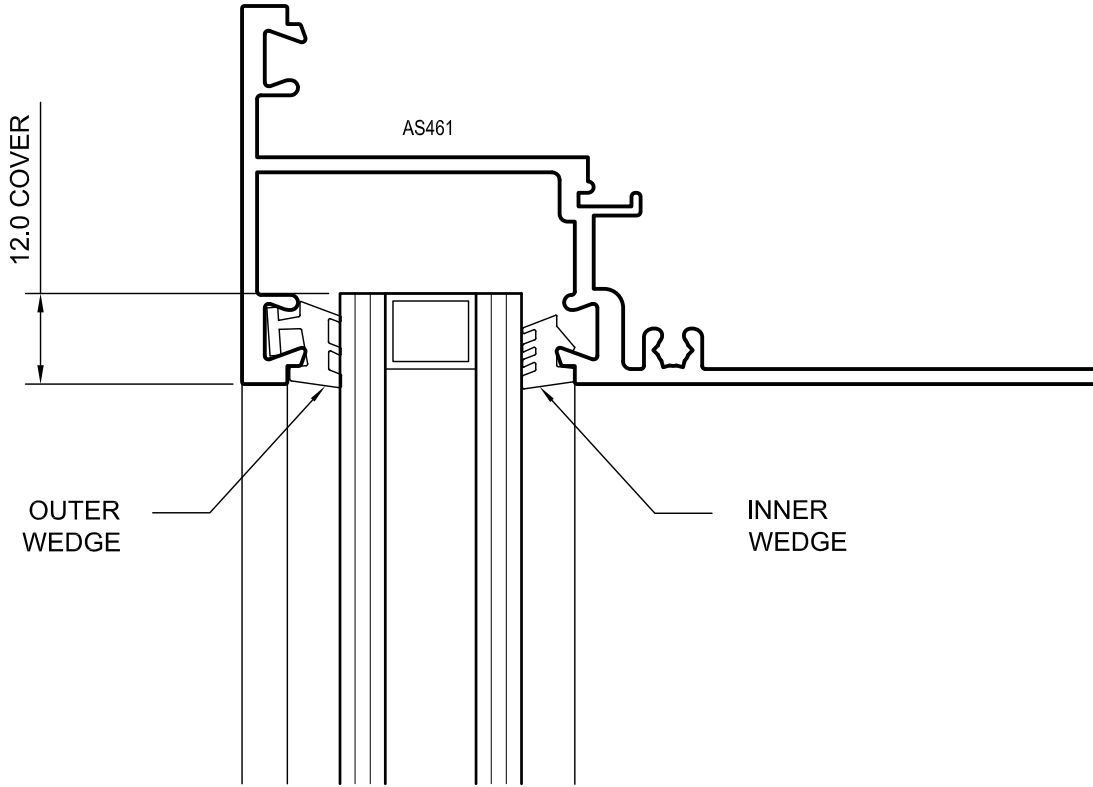

GLASS THICKNESS	OUTER WEDGE		INNER WEDGE	
	REF.	CODE	REF.	CODE
24mm THICK	CE16	376353	GR4	376021
26mm THICK	CE16	376353	GR3	376015
28mm THICK	CE16	376353	GR2	376012

REVERSE GLAZING WEDGE COMBINATIONS FOR EXTERNAL GLAZING