

Triser Hinged 3 Point Kit

Fitting Instructions

Cutout Details

Both sides of the door stile must be cut out to the dimensions below. All dimensions in millimetres.

Mounting of handles **BELOW** (LOW) door centreline

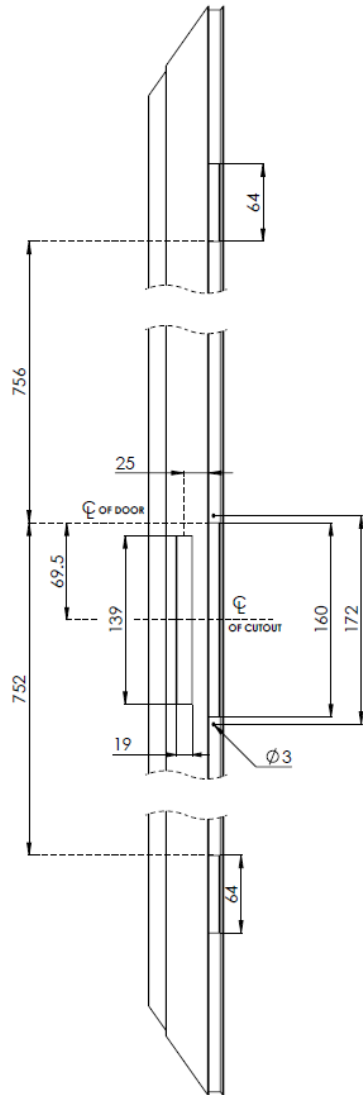

Mounting of handles **ABOVE** (HIGH) door centreline

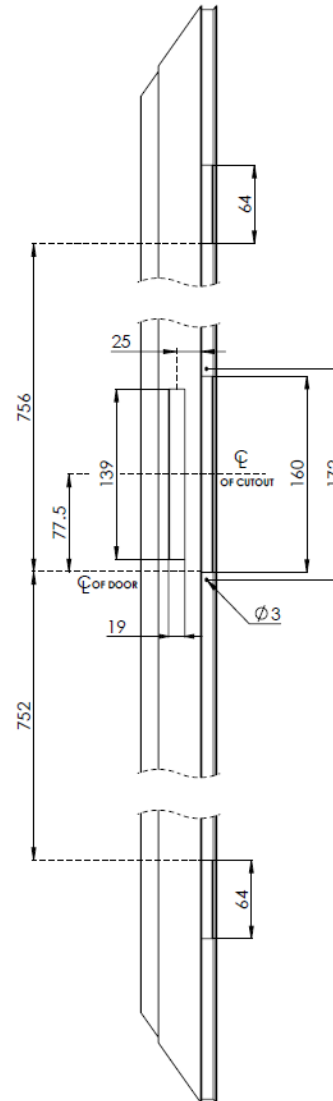

Fitting Instructions

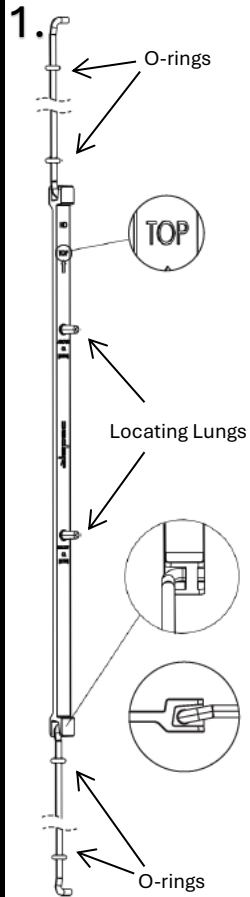

Assemble the rod and actuator bar as shown, with the 'TOP' mark facing up.

Starting with the bottom rod, insert the rod assembly through the top cut-out and slide it into the door section.

Keep the rod protruding out the top cut-out then attach the top multi point and push it into place.

Next, pull the bottom rod end through the bottom cut-out, connect it to the bottom multi point lock, and push it into place.

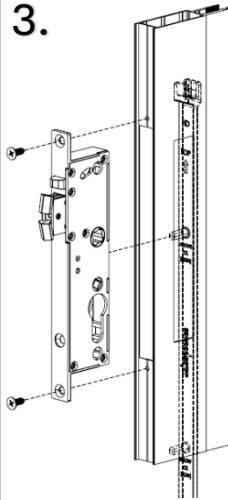
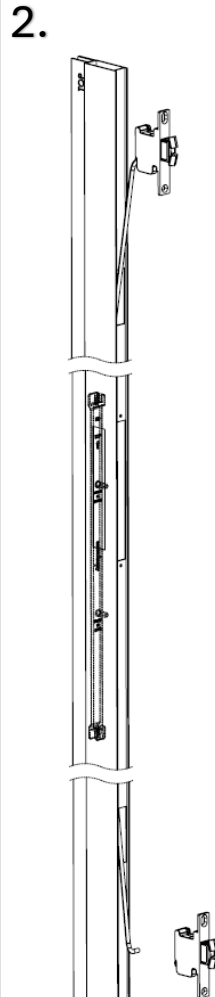

With the lock bolt extended and deadlocked, insert the centre lock into the cutout, ensuring the actuating bar's locating lug engages. Secure the lock with two 12mm CSK screws.

Insert the cylinder with the cam facing the door front and secure with the 32mm CSK screw. Avoiding overtightening.

Insert key and check the lock's functionality.

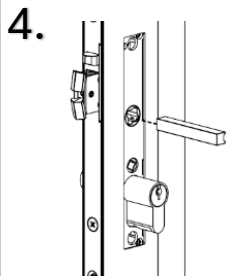
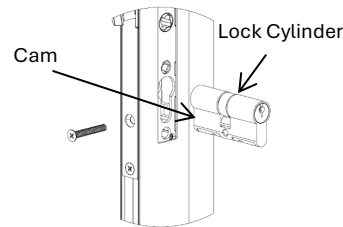

Insert the spindle into the lock body.

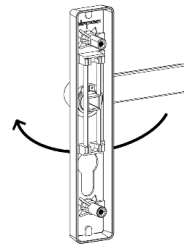

Prepare furniture plates by rotating the level downwards to the required handing position.

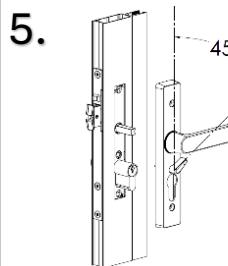

Ensure the snib is positioned at a 45° angle and is on the inside face of the door stile.

Secure the furniture plates as indicated above, using 25mm CSK screws, then insert the concealed fixing screw caps.

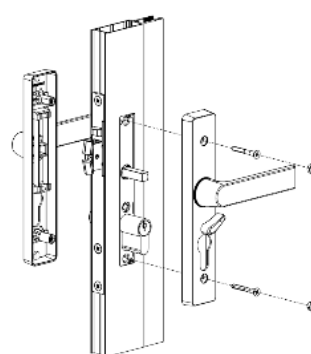

6.

Insert the key into the cylinder and check the operation of the handle, multi point locks and centre lock.

Confirm that the bolts retract smoothly and that the bolt/handle cannot be operated when in deadlock position.

Place the main lock into the deadlock position and push the top multipoint lock until the hook bolt is full extended.

Drill a 3mm hole in the centre of the large slot and lightly fix the screw.

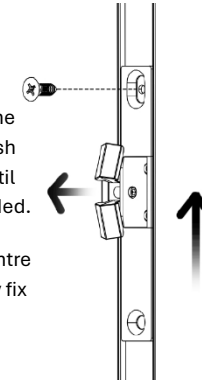

Test the key and snib to ensure the multipoint bolt is deadlocked in the locked position and flush in the unlocked position.

Ensure the multipoint bolt doesn't depress when pressure is applied when locked. Make any necessary adjustments.

Drill and fasten the remaining screw, then tighten the initial screw. Check the top multipoint lock functioning with the snip and key.

Repeat process for bottom multipoint lock.

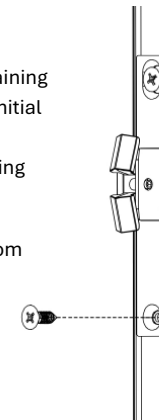

7.

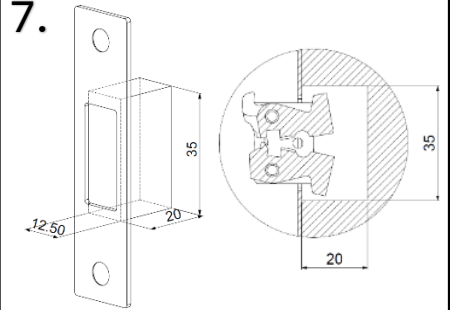

Close the door and mark the jamb at the centre of the main hook bolt and multipoint locks. Then cut a 20x35mm bolt recess from the centre of the mark.

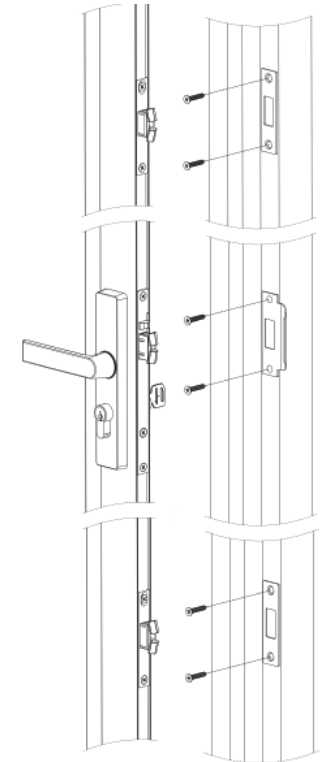

Line up the strikers and secure with 25mm CSK screws.

NOTE: For proper lock operation ensure a 3-4mm clearance between the door frame and the jamb.