

1. Prepare Cutouts For Lock

Cutout machined on the inside face of the lock stile.

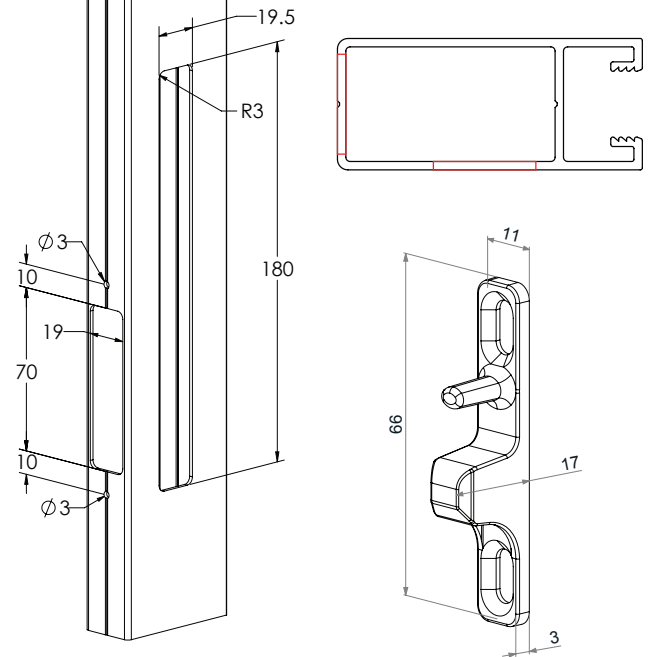

2. Fit Lock Into Section

Fit bottom end of the lock into the cutout and then press the top end until the top securing wedge clips into place.

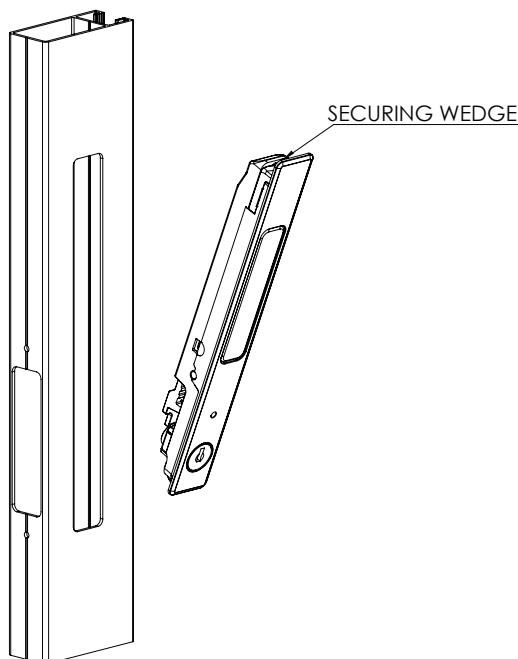

3. Fit Anti-Lift Plate

Insert the alignment tool into the side of the lock body as shown in the detail side view.

- Place the anti-lift plate over the alignment tool and into the side cutout.
- Mark and drill two 3.5mm holes centrally within the slots in the anti-lift plate (if not pre-drilled).
- Secure the anti-lift plate with two fixing screws then remove the alignment tool.

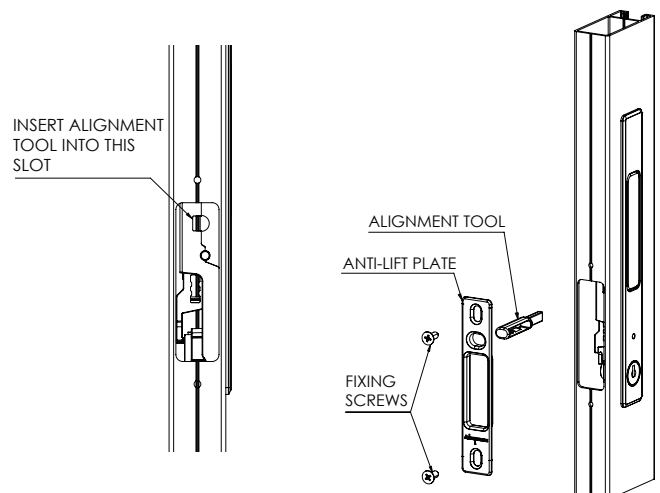

4. Install And Adjust Break

- Press push plate completely in and then insert 2.5mm hex key into the beak securing screw.
- Insert the beak into the lock body as shown and tighten the beak securing screw.
- NOTE: The beak can also be adjusted horizontally after the window is fitted.

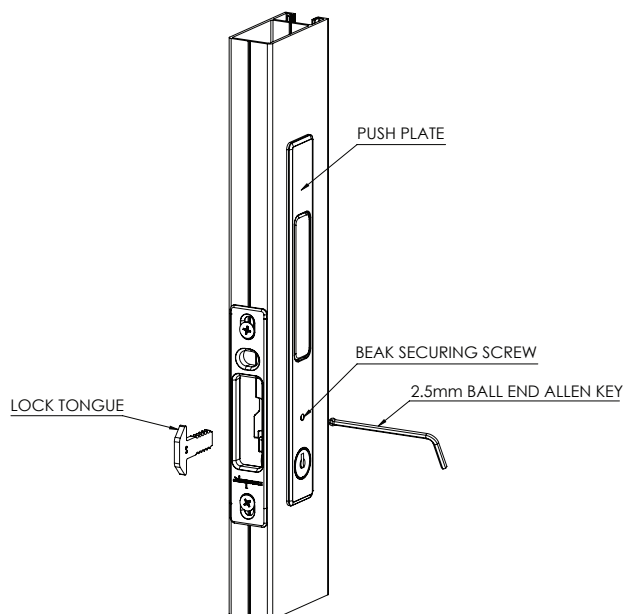

5. Install Catch Plate

- Prepare jamb and secure the catch plate using two fixing screws.
- Open and close window to check alignment of the catch and the position of the beak.
- Adjust beak and/or catch if necessary.

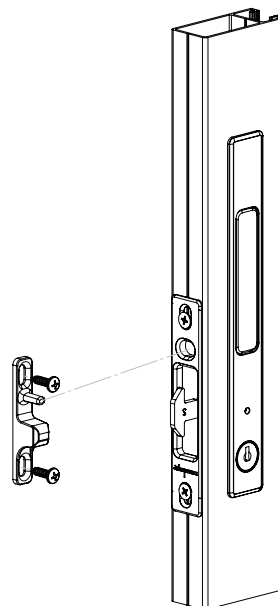

6. Removal Of Lock

- Remove the beak (Step 2 in reverse)
- If possible, insert a metal bar down through the top of the window section to push down the top securing wedge and remove the lock.

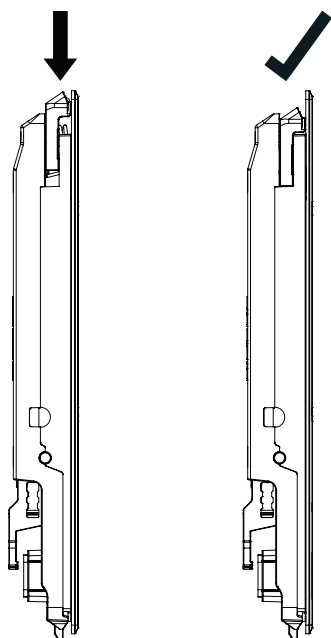

7. Carinya Thermally Broken Sliding Window Option

In the case you are constructing a Carinya Thermally Broken Sliding Window please ensure you are using the Offset Tongue and the Base Plate for the Striker.

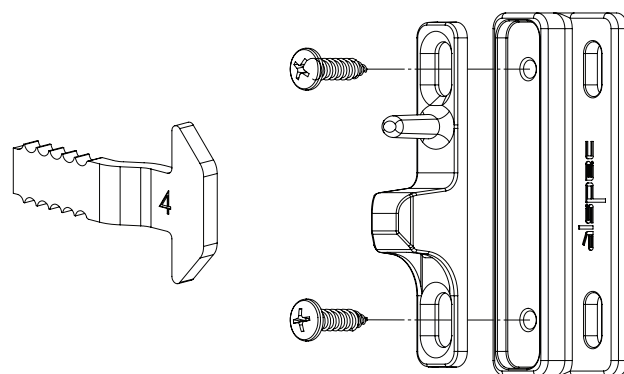

Offset Tongue

Striker and base plate