

## Triser Sliding 3 Point Kit

### Fitting Instructions

#### Cutout Details

Both sides of the door stile must be cutout to the dimensions below. All dimensions in millimetres.

Mounting of handles **BELOW** (LOW) door centreline

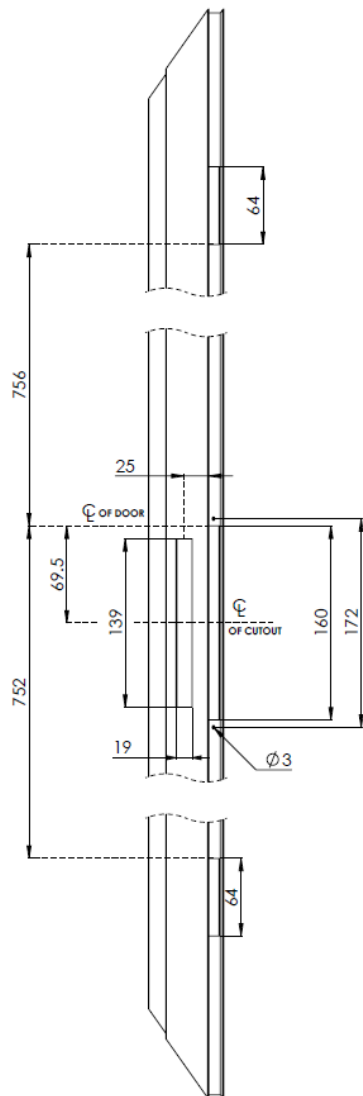

Mounting of handles **ABOVE** (HIGH) door centreline

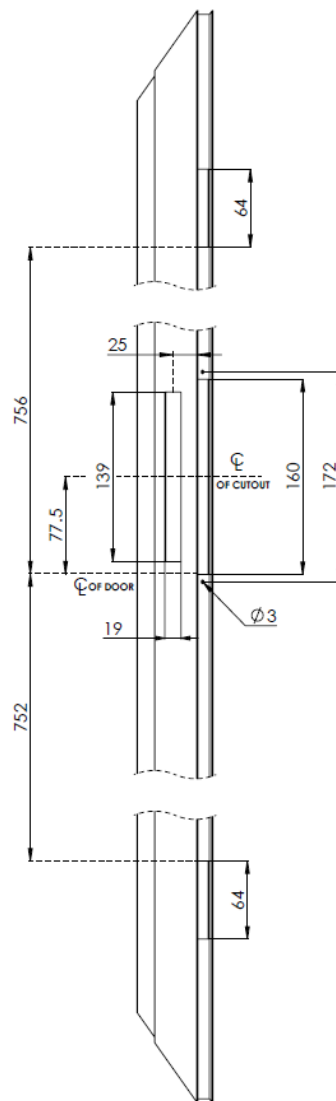

## Fitting Instructions

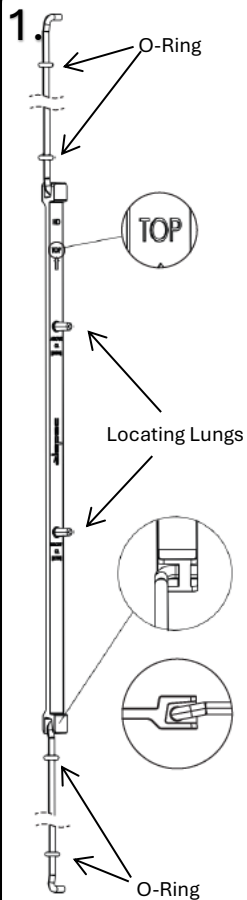

Assemble the rod and actuator bar as shown, with the 'TOP' mark facing up.

Starting with the bottom rod, insert the rod assembly through the top cut-out and slide it into the door section.

Keep the rod protruding out the top cut-out then attach the top multi point and push it into place.

Next, pull the bottom rod end through the bottom cut-out, connect it to the bottom multi point lock, and push it into place.

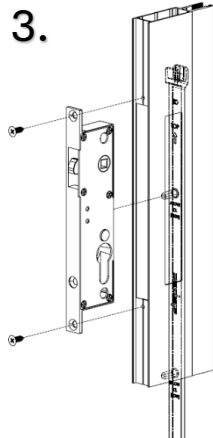
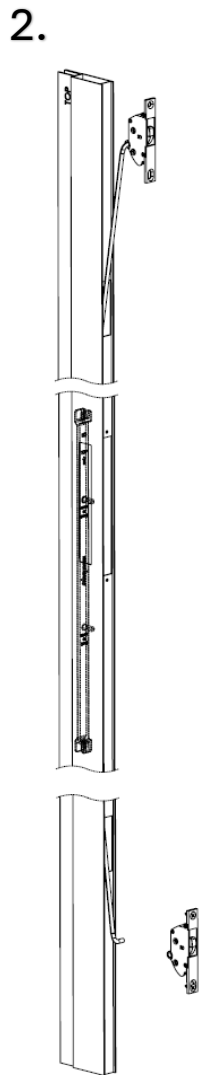

Insert the centre lock into the cutout, ensuring the actuating bar's locating lug engages. Secure with two 12mm CSK screws.

Insert the cylinder with the cam facing the door front and secure with the 32mm CSK screw, avoiding overtightening.

Insert key and check the lock's functionality.

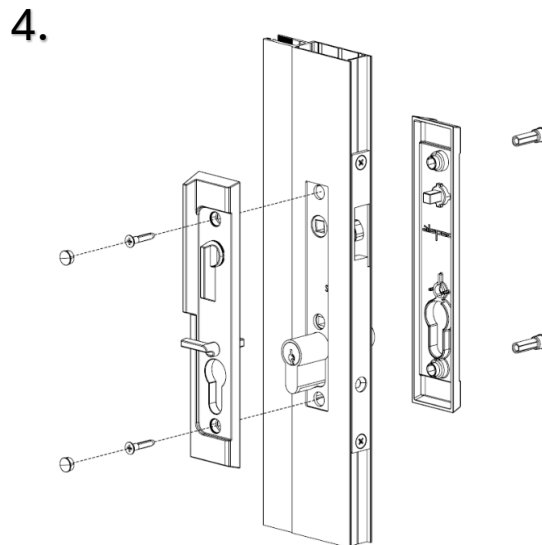
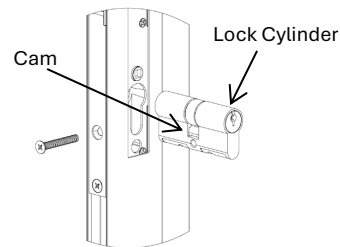

Secure the furniture plates as indicated above, using 25mm CSK screws, then insert the hole mounting plugs. Ensure that the snib is located on the inside of the door.

*For further installation detail, reference the ASIM Sliding Hook Bolt Security Lock Instructions*

5. Insert the key into the cylinder and check the operation of the handle, multi point locks and centre lock.

Confirm that the hooks retract smoothly and that the hooks/handle cannot be operated when in deadlock position.

Place the main lock into the deadlock position and push the top multipoint lock until the lock hook is full extended.

Drill a 3mm hole in the centre of the large slot and lightly fix the screw.

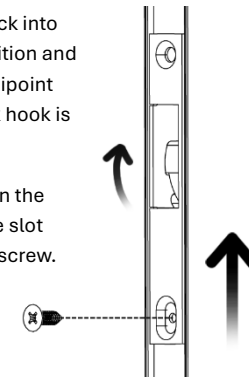

Test the key and snib to ensure the multipoint hook is deadlocked in the locked position and retracted in the unlocked position.

Ensure the multipoint hook doesn't depress when pressure is applied when locked. Make any necessary adjustments to ensure full engagement of the multipoint lock.

Drill and fasten the remaining screw, then tighten the initial screw. Check the top multipoint lock functioning with the snib and key.

Repeat process for bottom multipoint lock.

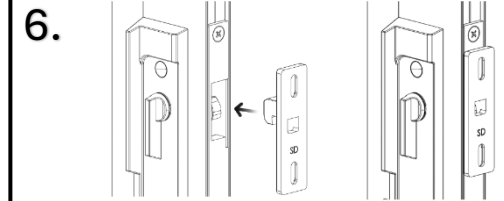
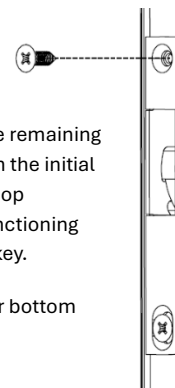

To mounting the strikers to the jamb, insert the strikers into the lock body and multipoint locks.

Next peel the backing on the double-sided tape off the striker and allow the striker to stick to the jamb when the door is shut. Unlock the door and remove the strikers from the locks.

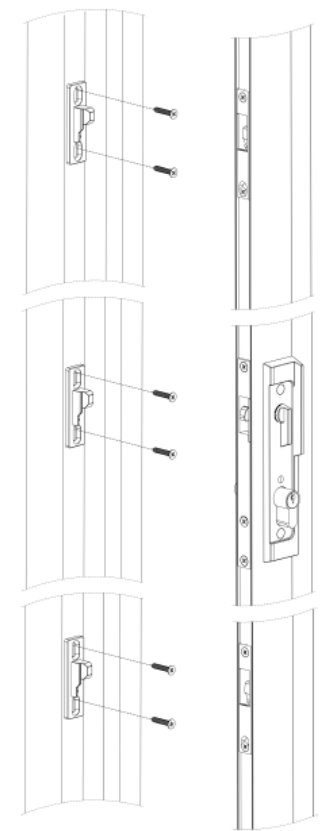

Fix the main lock and multipoint strikers with 25mm CSK screws.

**Operation Test:** Rotate the key to lock/unlock the main bolt, handles and snib, ensuring the product operates smoothly.